



# Mobicaris Companion™

**Optimizing your digital transformation  
Effortless, fast and scalable**

## Locating & Sensing IoT platform for indoor and outdoor industrial applications

**Introducing Mobicaris Companion™ - a powerful solution making smart, digital industries a reality.**

Mobicaris Companion™ is a unique, scalable full site coverage solution with seamless location functionality inside and outside, generating real-time data on positions, movements, and environmental factors such as air quality and temperature.

With Companion, you can send notifications to people at the site, and receive notifications back. The solution is industry certified, guaranteeing reliable performance in even the toughest environments.

## Your complete IoT platform

The Companion™ solution is a complete platform including both hardware and software that together serve various use cases – ranging from asset tracking for improved efficiency, to the location of people to simplify compliance and safety at industrial sites.

### Hardware - Companion Tag Devices

Mobicaris Companion™ includes tag devices, with IP67 classified minimalistic design, making it suitable for tough industrial environments. The device is worn by people at the site who needs to be tracked and can be used to send notifications or alarms if needed.

When not in use, each device can be charged in the Mobicaris Companion charging station, ensuring full capacity when and where it matters.

### Software - Companion Engine

Companion Engine™ is the software part of for smooth deployment, maintenance and full control of indoor and outdoor locating and sensing.

**The Companion Engine solution is used to orchestrate:**

- System Manager
- Positioning data
- Environmental data
- APIs
- SDKs

# The Companion™ package

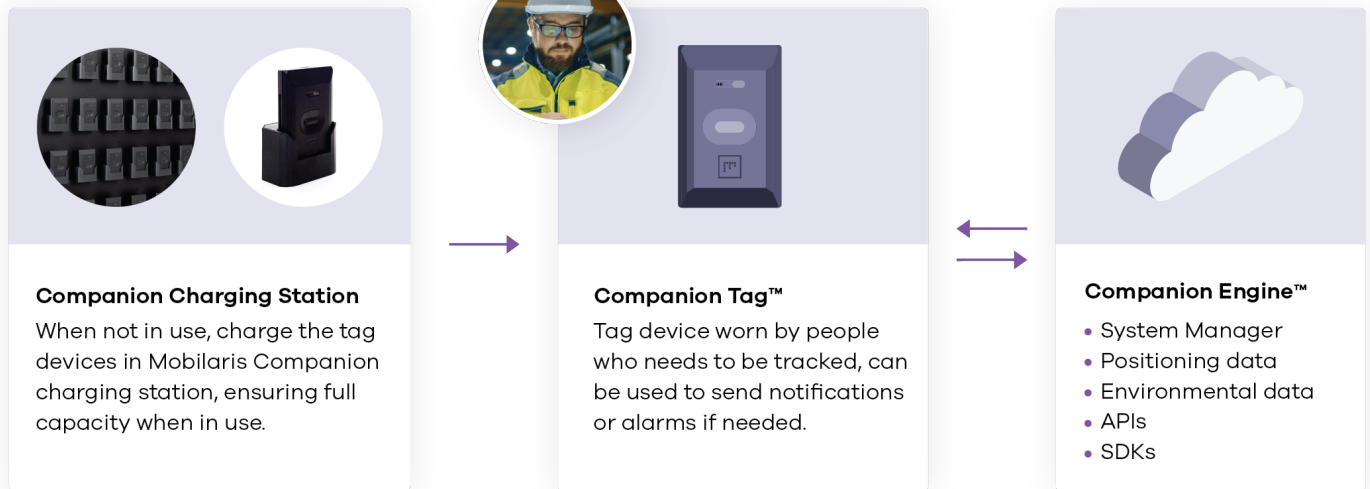

## Technical information

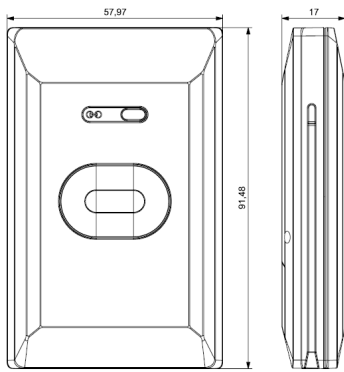

Width: 58 mm      Length: 91 mm  
Thickness: 17 mm      Weight: 86 g

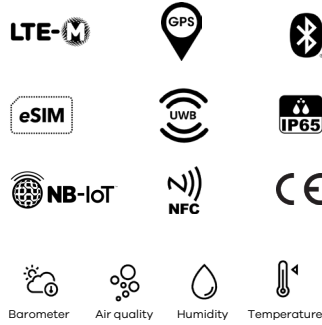

### Interfaces

- Battery, 1200 mAh
- Accelerometer and gyro: IMU  $\pm 2/\pm 4/\pm 8/\pm 16g$  full scale, 125/ $\pm 250/\pm 500/\pm 1000/\pm 2000$  dps full scale
- Environmental sensor:
  - Air quality sensor IAQ 0-50
  - Air pressure 300-1100 hPa
  - Humidity 0-100%
  - Temperature: -40-85°C
- USB-C
- Nano SIM per default
- options for eSIM support
- LTE NB-IOT, Bands 3, 4, 5, 8, 12, 13, 17, 20, 26, 28, 66
- LTE Cat-M, Bands 3, 4, 5, 8, 12, 13, 20, 26, 28, 66
- BLE 5.1
- GPS
- NFC Tag-A
- Ultra Wideband, Bands 1, 2, 3, 5
- Built-in buzzer, 49 dB

### Non-functional

- CE, FCC and IC certified
- Operating temperature: -20°C to +60°C
- Heat test: IEC 60068-2-2 Bb, +60°C 16h
- Cold test: IEC 60068-2-1 Ab, -20°C 16h
- IP class: IP65
- Drop test: MIL-STD-810G (26 drops 1,2m)

### Other

- FOTA compatible (Over the air updates)
- GPS & BLE updates => every 10 sec (configurable)
- Power saving modes by eDRx or PSM
- Up to 40h battery life



Mobilaris Locating & Sensing™

[mobilaris.se/ind](http://mobilaris.se/ind)

